

- Structural Steel
- Metalwork
- Steel Sales
- Aluminium
- Roofing
- Cladding
- Maintenance
- General Builders
- BBQ Spit Hire

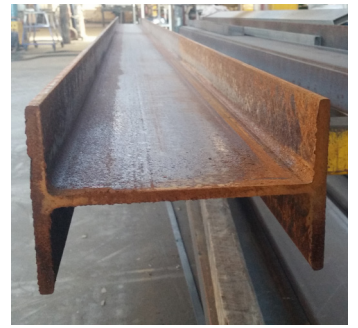

Universal Columns							
		A	B	C	D	E	R
	kg/m	mm	mm	mm	mm	mm	mm
100UC	14.8	97	99	7.0	83	5	10.0
150UC	23.4	152	152	6.8	139	6.1	8.9
	30.0	158	153	9.4	139	6.6	8.9
	37.2	162	154	11.5	139	8.1	8.9
200UC	46.2	203	203	11.0	181	7.3	11.4
	52.2	206	204	12.5	181	8.0	11.4
	59.5	210	205	14.2	181	9.3	11.4
250UC	72.9	254	254	14.2	225	8.6	14.0
	89.5	260	256	17.3	225	10.5	14.0
310UC	96.8	308	305	15.4	277	9.9	16.5
	118	315	307	18.7	277	11.9	16.5
	137	321	309	21.7	277	13.8	16.5
	158	327	311	25	277	15.7	16.5

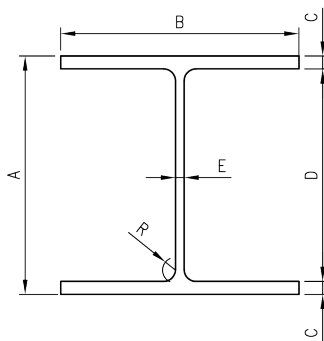

Universal Column

Section:
 Universal Column (UC)
 Standard: AS/NZS 3679.1
 Grade: 300 MPa

Available Cut to Length

Additional Services Available:

- Painting
- Drilling
- Welding
- Rolling
- Galvanising
- Angle Cutting